

INTRINSICALLY SAFE CAP LAMP with LED and 7Ah LI-ION accumulator TC2

BENONI
EAST LONDON
WELKOM (011) 741-3600
(043) 706-8200
(057) 353-1188

Email: marketing@battery.co.za
www.battery.co.za

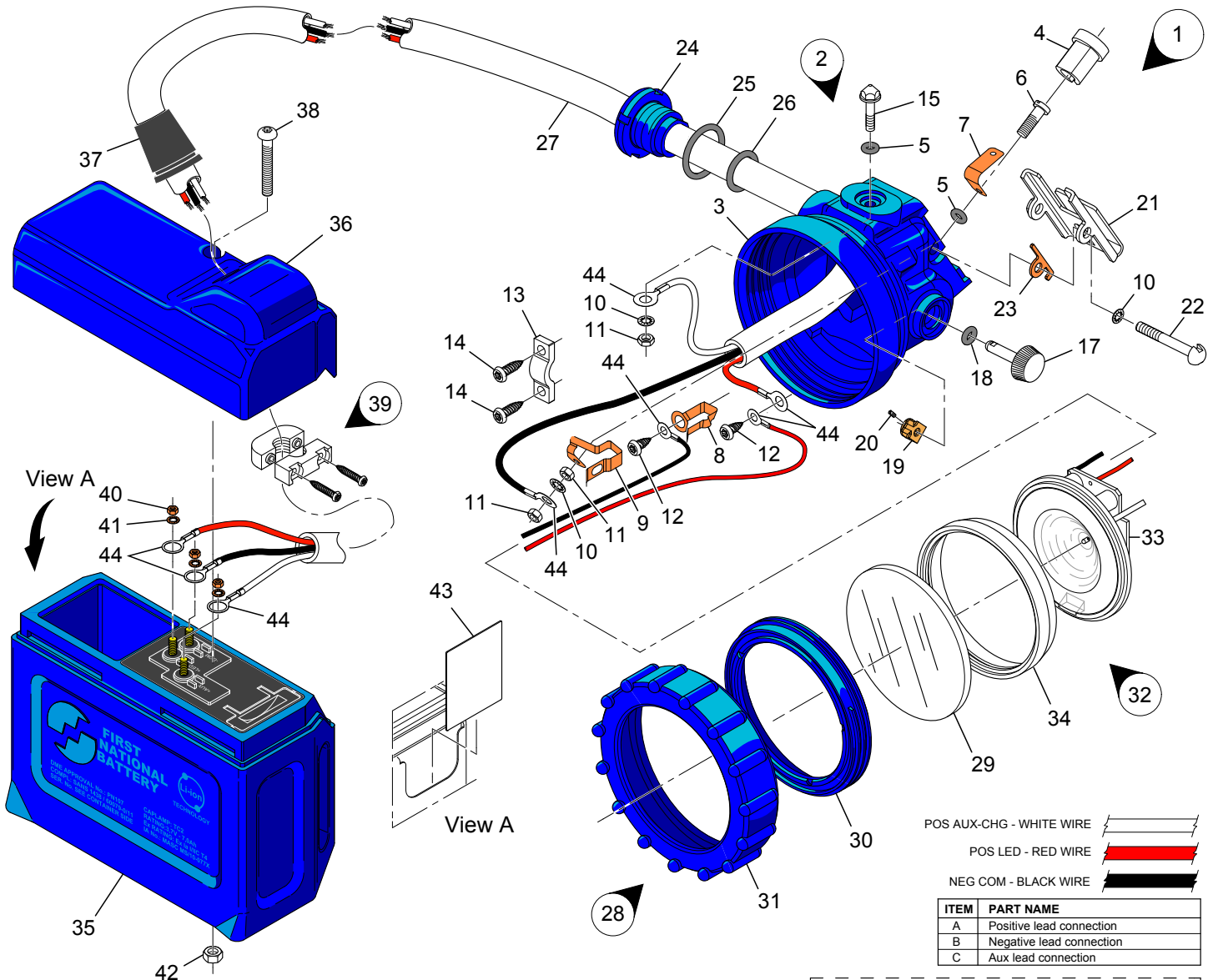

WARNING!

ONLY THE LED SHOWN HEREON MAY BE USED WITH THE LITHIUM-ION BATTERY.

THE USE OF ANY OTHER LIGHT WITH THIS BATTERY WILL RENDER THE LAMP UNSAFE AND THE WARRANTY VOID.

ITEM	QTY	DESCRIPTION	PART #
1	1	TC2 I/S LED Lamp Assembly Complete	105216
2	1	Cappro headpiece & Cable Complete	105201
3	1	Headpiece Moulding	105202
4	1	Lock Barrel	105224
5	2	O-Ring Lock Contact	105222
6	1	Lock Contact Screw	105214
7	1	Lock Contact	105223
8	1	Switch Blade Contact	105209
9	1	Switch Contact	105210
10	3	Lock Washer	105271
11	3	Nut Charge Contact	105212
12	2	Switch Contact Screw	105272
13	1	Cable Hold Down	105213
14	2	Cable Holddown Screw	105217
15	1	Charge Contact Screw	105230
16	1	Washer Charge Contact	105231
17	1	Switch Knob	105228
18	1	O-Ring Switch Knob	105229
19	1	Switch Blade	105218
20	1	Switch blade grub screw	105219
21	1	Cap Hook Assembly	105227
22	1	Cap Hook Screw	105226
23	1	Lock Spring	105225
24	1	Cable Securing Bush	105220
25	1	O-Ring Cable Bush	105221
26	1	O-Ring Cable Seal	105232
27	1	Cable Assembly 1.6m	105207

HINTS

1. Ensure by regular checking that the chargers are correctly adjusted.
2. Monitor the repair work being done by the lamproom staff.
3. Ensure that the Caplamp and Accumulator comply to the local regulation i.e. sealed and locked prior to issuing.
4. Do regular charging frame checks i.e. charging keys, push button and loose connections.
5. Monitor "Lamps that started flashing before end of shift" to establish the problem area.
6. Ensure minimum time is lost in placing the lamp on the charging frame at the end of shift.
7. Once the lamps are on charge, inspect for loose or broken outer covers, damaged headpieces and cables.
8. Lamps used on different shifts should be, as far as possible, segregated.

28	1	Headpiece Assembly	105274
29	1	Lens	105204
30	1	LED Channel Gasket	105203
31	1	Impact Ring - Green	105253
		Impact Ring - Yellow	105254
		Impact Ring - Red	105255
		Impact Ring - Orange	105256
		Impact Ring - White	105257
		Impact Ring - Blue	105270
32	1	Cappro LED Assembly	105205
33	1	LED PCB	105275
34	1	LED Channel Gasket	105286
35	1	TC-2 I/S Li-Ion Battery w/o RFID	105234
36	1	TC-2 Outer Cover	105236
37	1	Cable Grommet	105248
38	1	Outer Cover Retaining Screw	105246
39	1	Cable Clamp Kit	105250
40	5	Terminal Nut	105249
41	5	Terminal Lock Washer	105251
42	1	Outer Cover Lock Nut	105247
43	1	Number Check Plate (Stainless Steel)	105287
44	8	3.5mm Lugs	105285

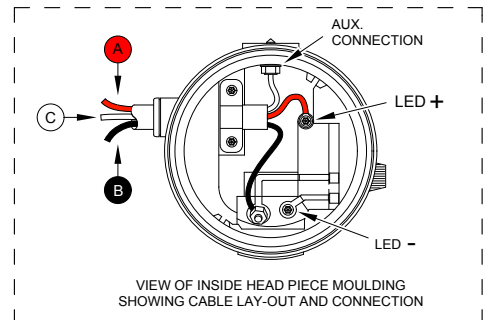

VIEW OF INSIDE HEAD PIECE MOULDING
SHOWING CABLE LAY-OUT AND CONNECTION

SUB-ASSEMBLY DESCRIPTION	PART #
TC2 I/S Li-Ion Battery	105234
Head piece cable and Cover	105273
Head piece Assembly	105274

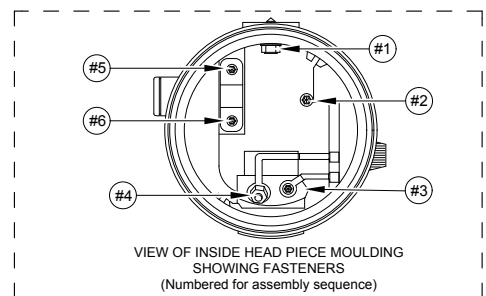

VIEW OF INSIDE HEAD PIECE MOULDING
SHOWING FASTENERS
(Numbered for assembly sequence)